

PLANIMETRIA TRACCIATO NUOVE TUBAZIONI IN PROGETTO
SCALA 1:200

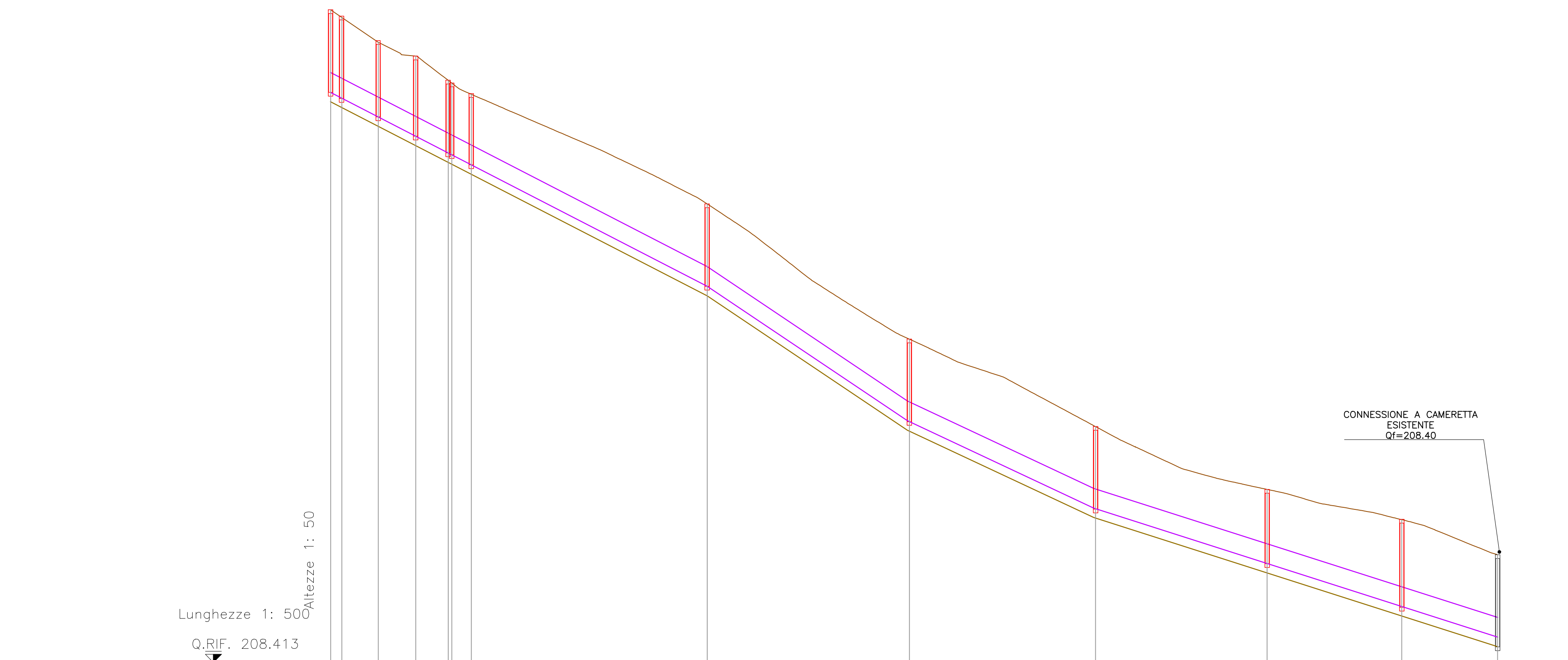

SEDE DI POSA	STRADA STERRATA	STRADA COMUNALE
LIVELLETTE	D=-2.142 L=1.920 P2=-5.1112	D=-2.058 L=64.351 P2=-3.1982
RICOPRIMENTO	-1.00 -0.99 -0.96 -0.88	-1.00 -1.00 -0.99 -0.87



ID PICCHETTI	0.00 PZ1	0.00 PZ2	0.00 PZ3	0.00 PZ4	0.00 PZ5	0.00 PZ6	0.00 PZ7	0.00 PZ8	0.00 PZ9	0.00 PZ10	0.00 PZ11	0.00 PZ12	0.00 PZ13	0.00 PZ14	0.00 PZ15	0.00 PZ16	0.00 PZ17	0.00 PZ18	0.00 PZ19	0.00 PZ20	0.00 PZ21	0.00 PZ22	0.00 PZ23	0.00 PZ24	0.00 PZ25	0.00 PZ26	0.00 PZ27	0.00 PZ28	0.00 PZ29
DISTANZE PROGRESSIVE	0.00	0.00	0.00	0.00	0.00	0.00	0.00	0.00	0.00	0.00	0.00	0.00	0.00	0.00	0.00	0.00	0.00	0.00	0.00	0.00	0.00	0.00	0.00	0.00	0.00	0.00	0.00	0.00	0.00
DISTANZE PARZIALI	0.00	0.00	0.00	0.00	0.00	0.00	0.00	0.00	0.00	0.00	0.00	0.00	0.00	0.00	0.00	0.00	0.00	0.00	0.00	0.00	0.00	0.00	0.00	0.00	0.00	0.00	0.00	0.00	0.00
QUOTE TERRENO	0.00	0.00	0.00	0.00	0.00	0.00	0.00	0.00	0.00	0.00	0.00	0.00	0.00	0.00	0.00	0.00	0.00	0.00	0.00	0.00	0.00	0.00	0.00	0.00	0.00	0.00	0.00	0.00	0.00
QUOTE SCORRIMENTO	0.00	0.00	0.00	0.00	0.00	0.00	0.00	0.00	0.00	0.00	0.00	0.00	0.00	0.00	0.00	0.00	0.00	0.00	0.00	0.00	0.00	0.00	0.00	0.00	0.00	0.00	0.00	0.00	0.00
QUOTE CIELO	0.00	0.00	0.00	0.00	0.00	0.00	0.00	0.00	0.00	0.00	0.00	0.00	0.00	0.00	0.00	0.00	0.00	0.00	0.00	0.00	0.00	0.00	0.00	0.00	0.00	0.00	0.00	0.00	0.00
PROFONDITA' SCAVO	0.00	0.00	0.00	0.00	0.00	0.00	0.00	0.00	0.00	0.00	0.00	0.00	0.00	0.00	0.00	0.00	0.00	0.00	0.00	0.00	0.00	0.00	0.00	0.00	0.00	0.00	0.00	0.00	0.00

SEZIONE TIPOLOGICA DI SCAVO E POSA
SCALA 1:20

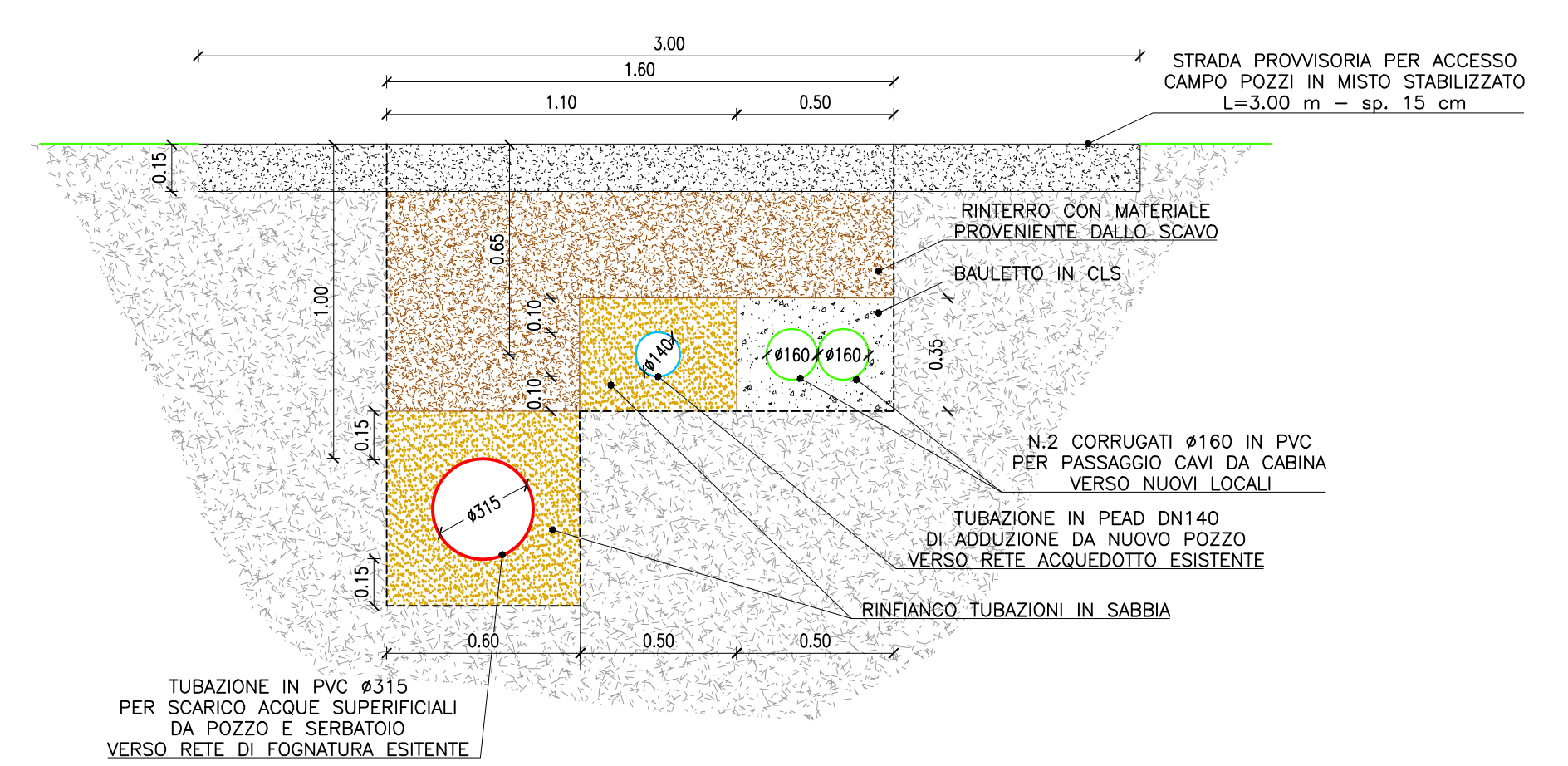

SEZIONE TIPOLOGICA RECINZIONE
SCALA 1:20

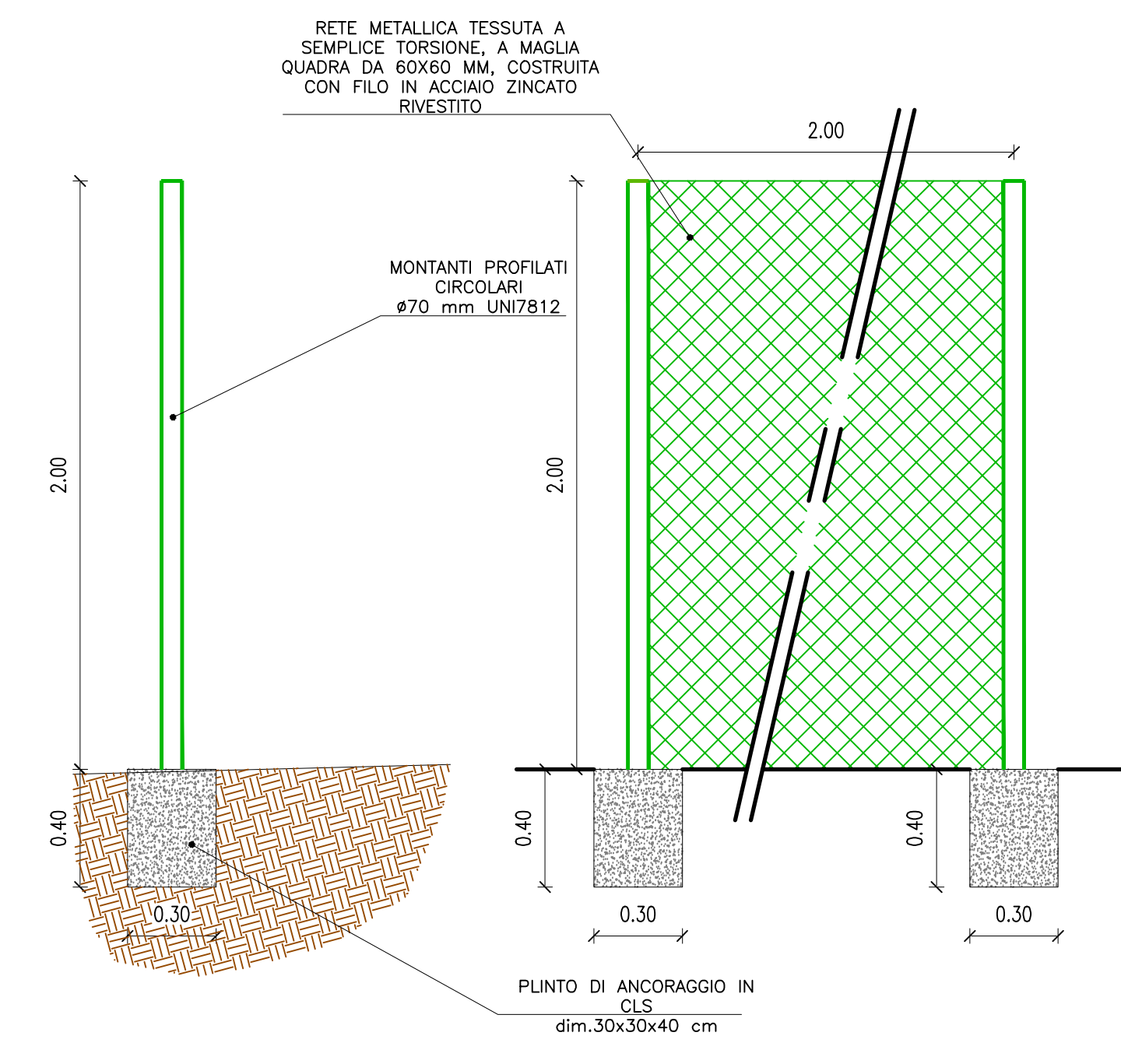

SEZIONE F-F
SCALA 1:50

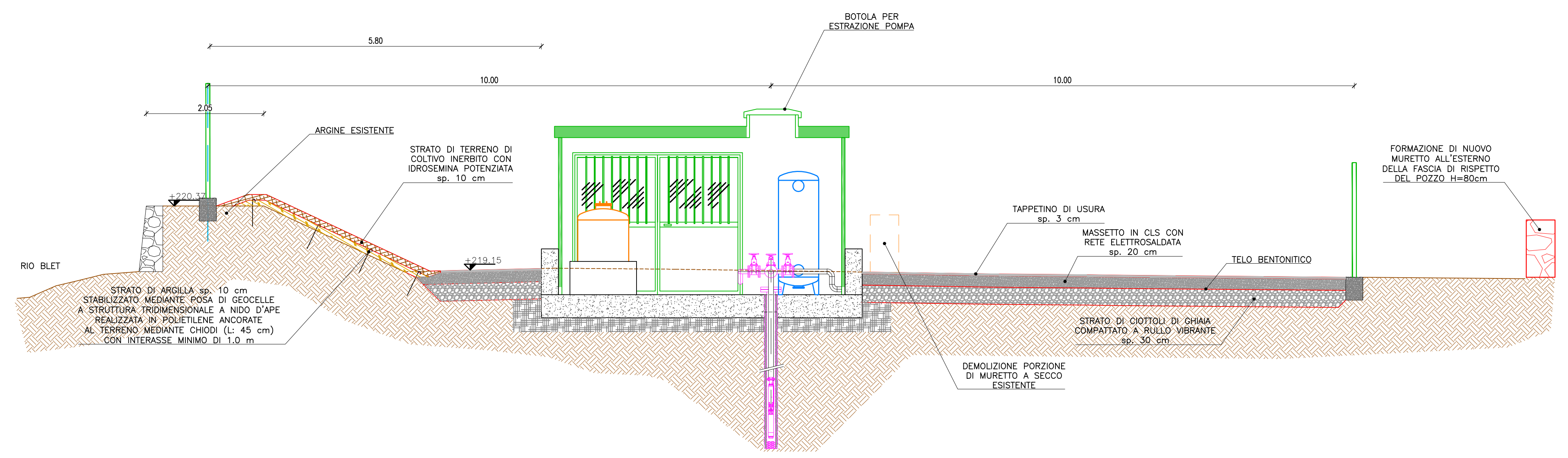

COMUNE DI ORNAVASSO (VB)



TITOLO COMMESA:
OPERE ACCESSORIE AL NUOVO POZZO MIGIANDONE IN COMUNE DI ORNAVASSO (VB), FRAZIONE MIGIANDONE

OGGETTO:
**PLANIMETRIA TUBAZIONE IN PROGETTO
PROFILO, SEZIONI E PARTICOLARI COSTRUTTIVI**

SCALA: **VARIE**

AVANZAMENTO PROGETTO: **ESECUTIVO** Data Rev. N° 0: **MARZO 2023**

Rev. N°	Modifica	Data
1	-	2/3/23
2	-	2/3/23
3	-	2/3/23
4	-	2/3/23

Rif. N° Commessa: **Y21N-10034340**

CUP: **D26H19000230005**

RUP: **Ing. Giuseppe Caranti**

I Progettisti: **Ing. Giovanni Battista Peduzzi**

Elaborato N°: **TAV. 4**

PROPRIETA' RISERVATA
QUESTO DISEGNO NON PUO' ESSERE RIPRODOTTO NE COMERCIALIZZATO A TERZI SENZA AUTORIZZAZIONE DI ACQUA NOVARA.VCO S.p.A.